

Bank Removal Dunces Arch Inclosure, Hampshire

HLS Ridge & Furrow, Stump and Bank Removal



Measured Survey and Archaeological Watching Brief Report



Prepared by the New Forest National Park Authority

for

Forestry England and the Verderers of the New Forest Higher Level Stewardship Scheme

27 June 2025

| Document Information | |
|-----------------------------|--|
| Document title | Dunces Arch Inclosure |
| Document subtitle | Measured Survey and Archaeological Watching Brief Report |
| Client | Forestry England and the Verderers of the New Forest Higher Level Stewardship Scheme |
| Site location | Dunces Arch Inclosure, New Forest |
| County | Hampshire |
| National grid reference | 431205,109187 (SU 31205 09187) |
| Document compiled by | Gareth Owen |
| Issued | 27/06/2025 |

CONTENTS

| | | |
|----|---------------------------|----|
| 1. | INTRODUCTION | 2 |
| 2. | AIMS AND OBJECTIVES | 2 |
| 3. | METHODOLOGY | 2 |
| 4. | RESULTS | 3 |
| 5. | COPYRIGHT | 3 |
| 6. | REFERENCES | 3 |
| 7. | FIGURES..... | 4 |
| 8. | PLATES..... | 10 |

LIST OF ILLUSTRATIONS

| | |
|--|----|
| Figure 1: Site location. | 4 |
| Figure 2: Map showing survey results for both segments of bank (and ditch), prior to removal. | 5 |
| Figure 3: Survey drawing of bank segment A, over base mapping. | 6 |
| Figure 4: Survey plan and sections of bank segment A..... | 7 |
| Figure 5: Survey drawing of bank segment B, over base mapping. | 8 |
| Figure 6: Survey plan and sections of bank segment B..... | 9 |
| Photo 1: Barrow, prior to groundworks. Looking east. | 10 |
| Photo 2: Barrow, post groundworks. Looking east. | 10 |
| Photo 3: Working photograph of barrow area. Looking east..... | 11 |
| Photo 4: Bank segment A. Looking south..... | 11 |
| Photo 5: Bank segment B. Looking south..... | 12 |

1. INTRODUCTION

- 1.1 In late 2023 the New Forest National Park Authority (NFNPA) Archaeology Team (HLS Archaeologist) conducted a measure survey (29 September) and subsequent archaeological watching brief (5 October) on clear fell restoration (ridge & furrow, stump and bank removal) work for Forestry England's HLS Team at Dunces Arch, Hampshire (centred on NGR: 431205,109187 (SU 31205 09187); Fig. 1).
- 1.1 This work was carried out as part of the New Forest Higher Level Stewardship (HLS) Scheme, which aims to restore and enhance the internationally important habitats of the New Forest and is a partnership between the Verderers of the New Forest, New Forest National Park Authority, Forestry England and Natural England.
- 1.2 Two sections of bank (and ditch) were removed to allow water to run across the area downhill for improved hydrology in the area.
- 1.3 Prior to the watching brief a hand measured surveyed of the bank (and ditch) segments, to be removed, was conducted.
- 1.4 Bank (and ditch) removal was undertaken by mechanical excavator not under archaeological supervision. The archaeological supervision was conducted on groundworks close to and on top of an un-scheduled Bronze Age barrow.
- 1.5 The fieldwork followed *Standards and guidance: Archaeological Watching Brief* (ClfA 2014).
- 1.6 The site was located at Dunces Arch Inclosure, New Forest, Hampshire approximately 1645m north-east of Lyndhurst and surrounded by New Forest Crown Land.

2. AIMS AND OBJECTIVES

- 2.1 The aims of the survey and watching brief were as follows:
 - To survey and record the two sections of bank (and ditch) prior to removal for the purposes of preservation by record;
 - to monitor groundworks close to the barrow to prevent any harm.

3. METHODOLOGY

- 3.1 Prior to the groundworks commencing a hand measured survey was conducted of both sections of bank, which had very faint traces of a ditch. The survey was conducted by hand with a total of four Temporary Bench Marks (TBM) being established using a Garmin eTrex GPS and OS Locate App on a smart phone (Fig. 2).
- 3.2 During groundworks a total of 49 metres of bank (and ditch) were removed, segment "A" 34m and segment "B" 15m long, leaving the rest of the bank (and ditch) in place, (Photos. 4 & 5).
- 3.3 The banks were reduced and any ditch infilled by a mechanical tracked excavator equipped with a toothed bucket, through the levelling of the bank and backfilling the material into the ditch to create a level surface. This work was not archaeologically monitored.
- 3.4 Ridge & furrow, stump and brash removal close to the barrow was undertaken under constant archaeological supervision. Prior to work commencing the area of the barrow had been marked up (bamboo canes and red and white hazard tape) including a buffer area.

- 3.5 All surface brash was removed by hand. The tracked excavator worked in and from within the buffer area only, reaching into (over) the barrow itself. Ground disturbance was kept to a minimum within the exclusion and buffer zone, (Photos. 1-3).

4. RESULTS

- 4.1 The removed bank and ditch segments were successfully surveyed and recorded prior to their removal (Figs. 2 - 6).
- 4.2 No unknown archaeological features or artefacts were encountered within the monitored groundworks and there were no negative impacts to the barrow.
- 4.3 Despite the scanning of disturbed soils, no finds of archaeological significance were recovered.

5. COPYRIGHT

- 5.1 The New Forest National Park Authority shall retain full copyright of any report under the Copyright, Designs and Patents Act 1988 with all rights reserved, excepting that it hereby provides an exclusive licence to the Client for the use of the report by the Client in all matters directly relating to the project as described in the specification. Any document produced may be freely copied for planning, development control, education and research purposes without recourse to the Copyright owner subject to all due and appropriate acknowledgements being provided.
- 5.2 This report and the archive generally, may contain material that is non New Forest National Park Authority copyright (e.g. Ordnance Survey, British Geological Survey, Crown Copyright), or the intellectual property of third parties, which we are able to provide for limited reproduction under the terms of our own copyright licences, but for which copyright itself is non-transferable by the New Forest National Park Authority. All remain bound by the conditions of the Copyright, Designs and Patents Act 1988 with regard to multiple copying and electronic dissemination of this document and subsequent report.

Archaeologically Monitored Groundworks

6. REFERENCES

CIfA 2014 Standards and guidance: Archaeological Watching Brief.

NFNPA 2023 Dunces Arch Inclosure - HLS Archaeological Constraints Evaluation - V1_1 in the New Forest Beat.

7. FIGURES

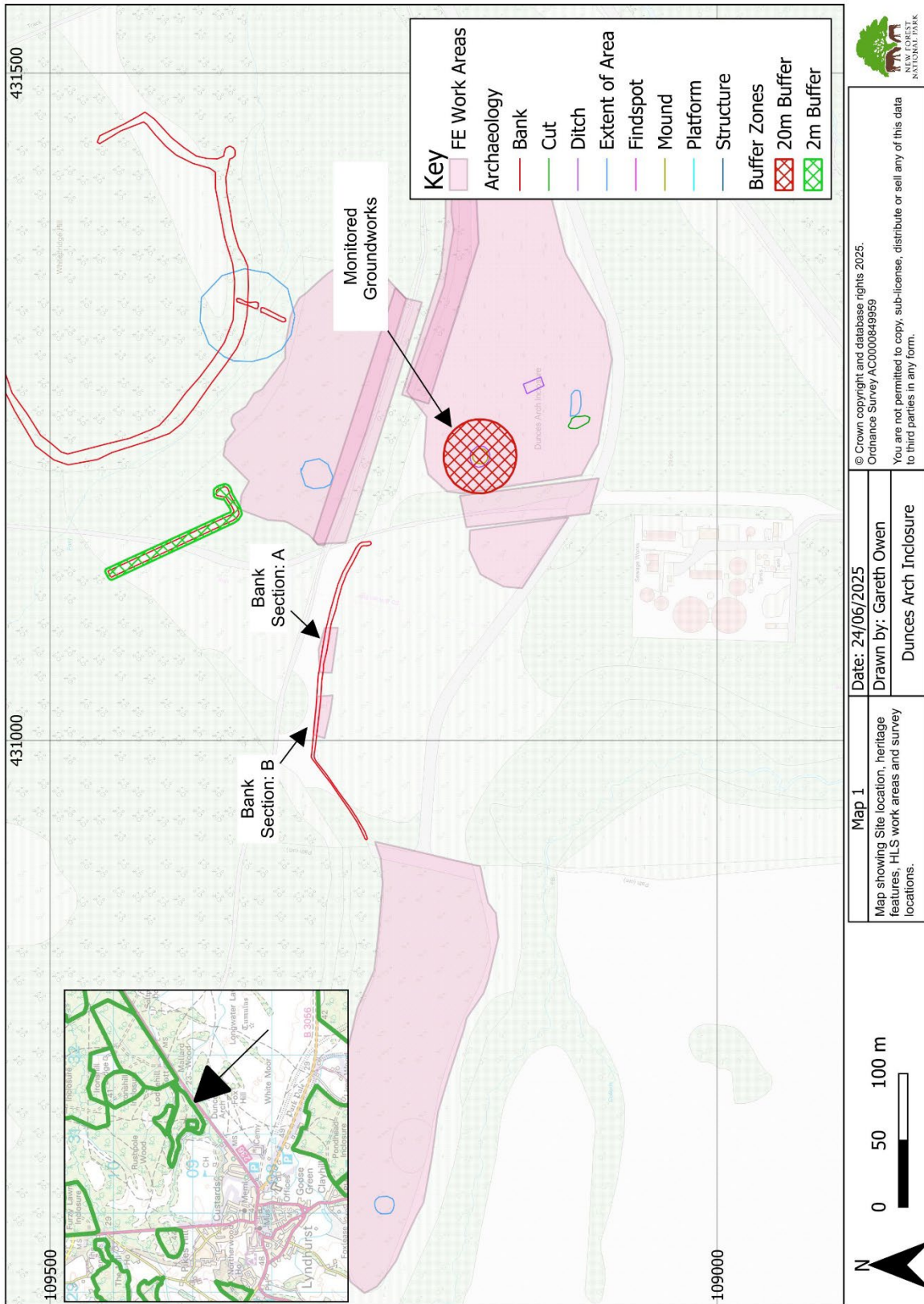

Figure 1: Site location.

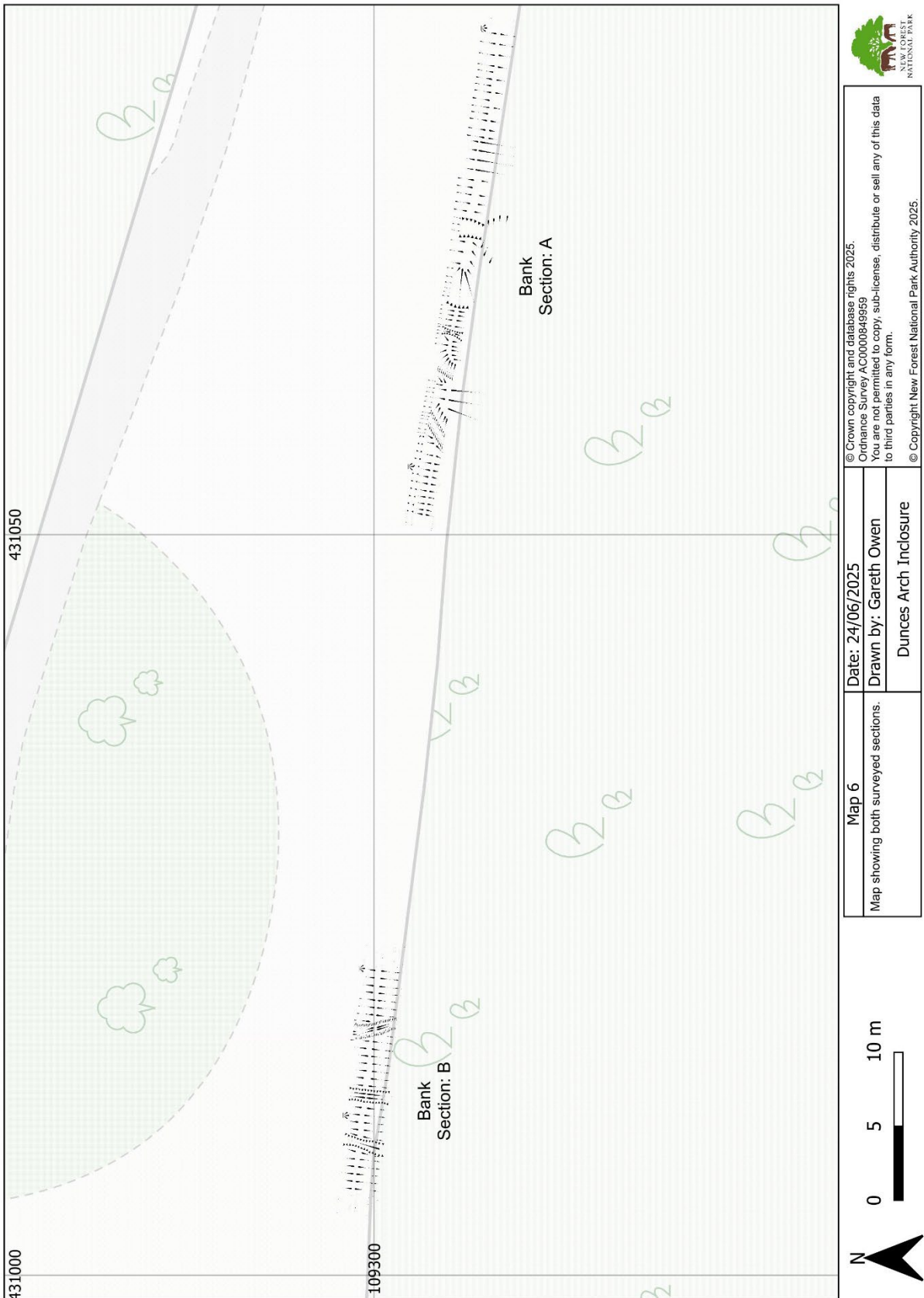
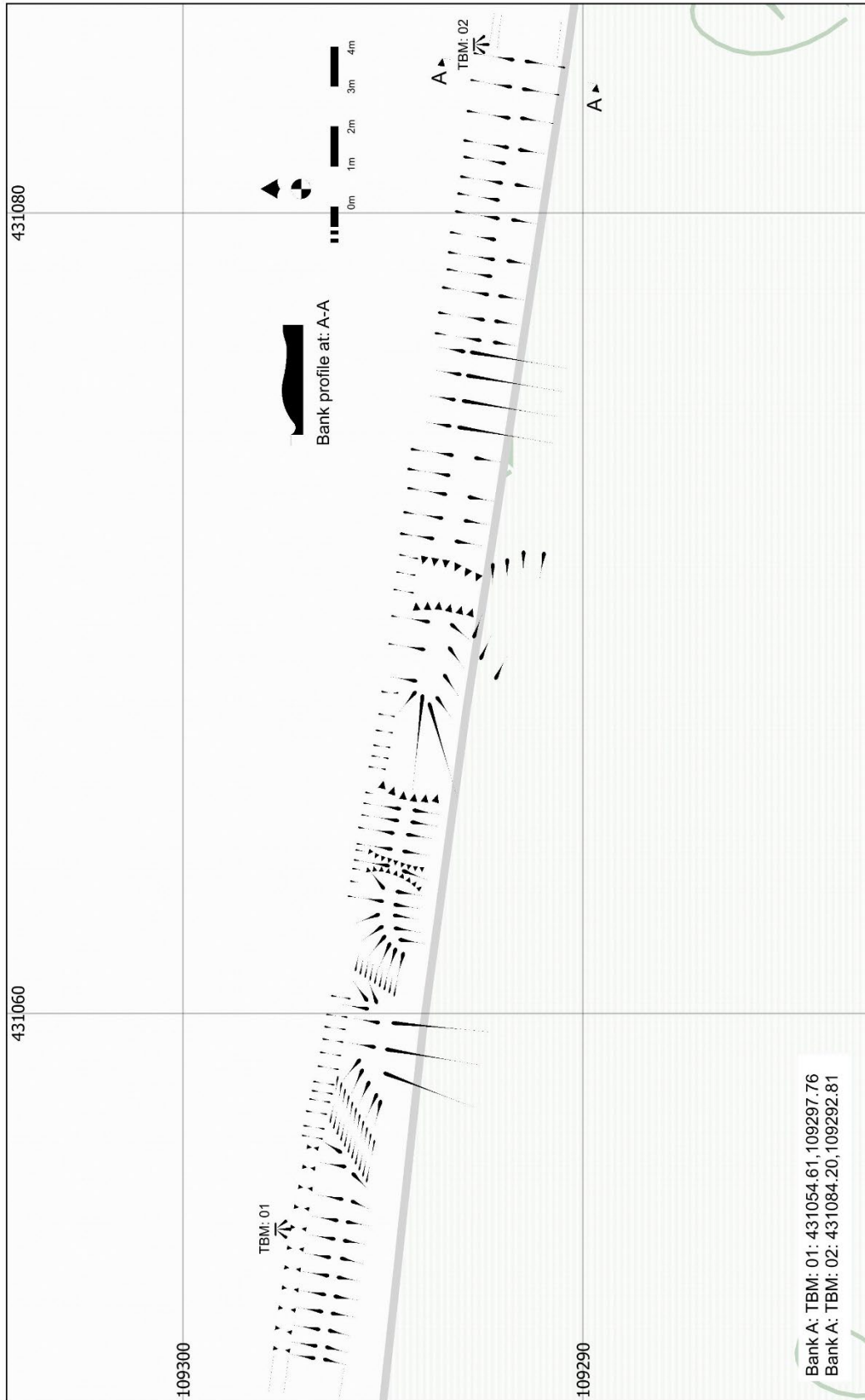
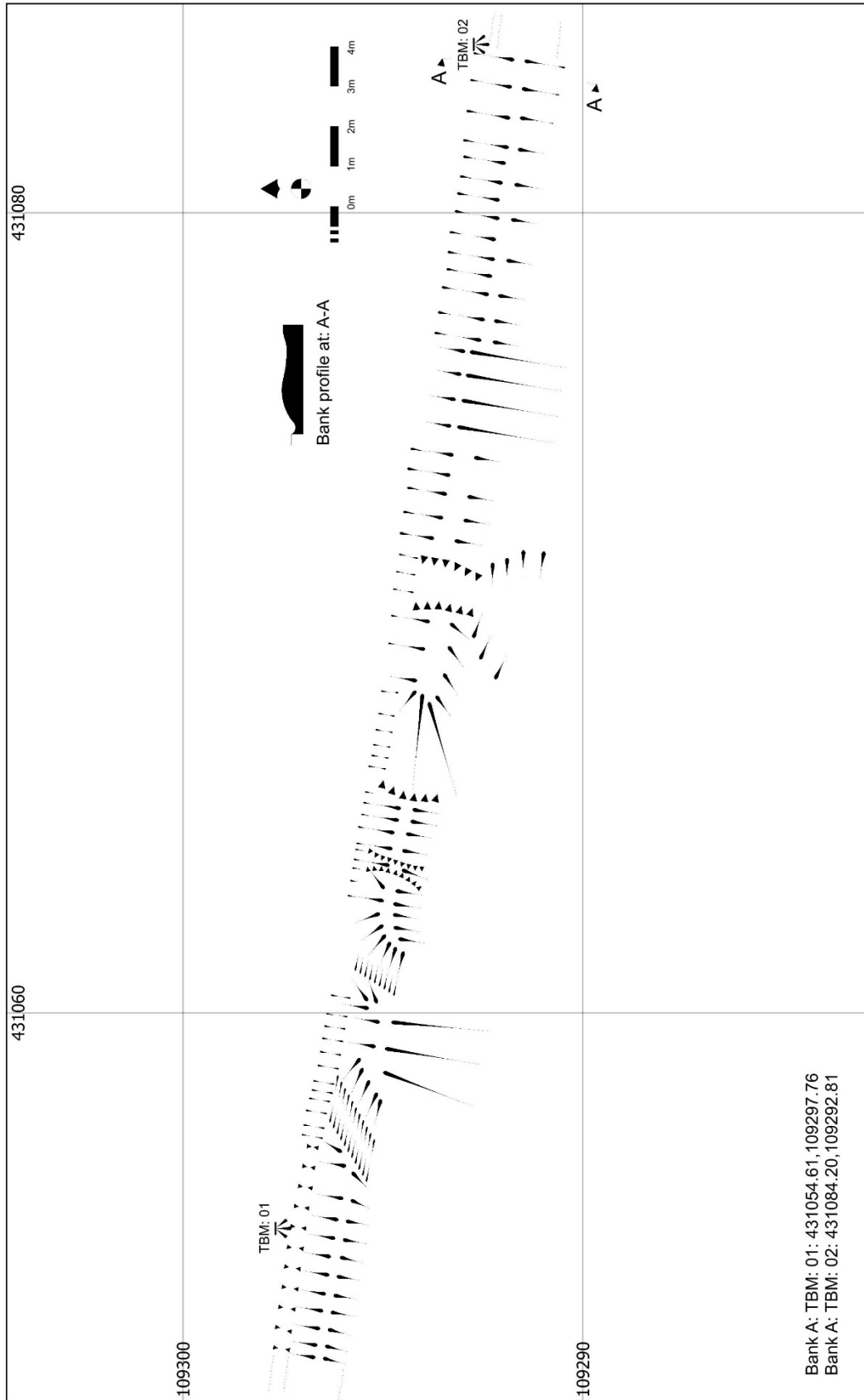

Figure 2: Map showing survey results for both segments of bank (and ditch), prior to removal.



| | | |
|--|--|--|
| Map: 3 Plan and profile of bank Section A. | Date: 24/06/2025 | © Crown copyright and database rights 2025. Ordnance Survey AC0000849559 You are not permitted to copy, sub-license, distribute or sell any of this data to third parties in any form. © Copyright New Forest National Park Authority 2025. |
| | Drawn by: GDO Dunces Arch Inclosure | |

Figure 3: Survey drawing of bank segment A, over base mapping.



| | | |
|---|------------------|-----------------------|
| Map: 3i Plan and profile of bank Section A. | Date: 24/06/2025 | Dunces Arch Inclosure |
| | Drawn by: GDO | |

© Crown copyright and database rights 2025.
Ordnance Survey AC0000849959
You are not permitted to copy, sub-license, distribute or sell any of this data to third parties in any form.
© Copyright New Forest National Park Authority 2025.

Figure 4: Survey plan and sections of bank segment A.

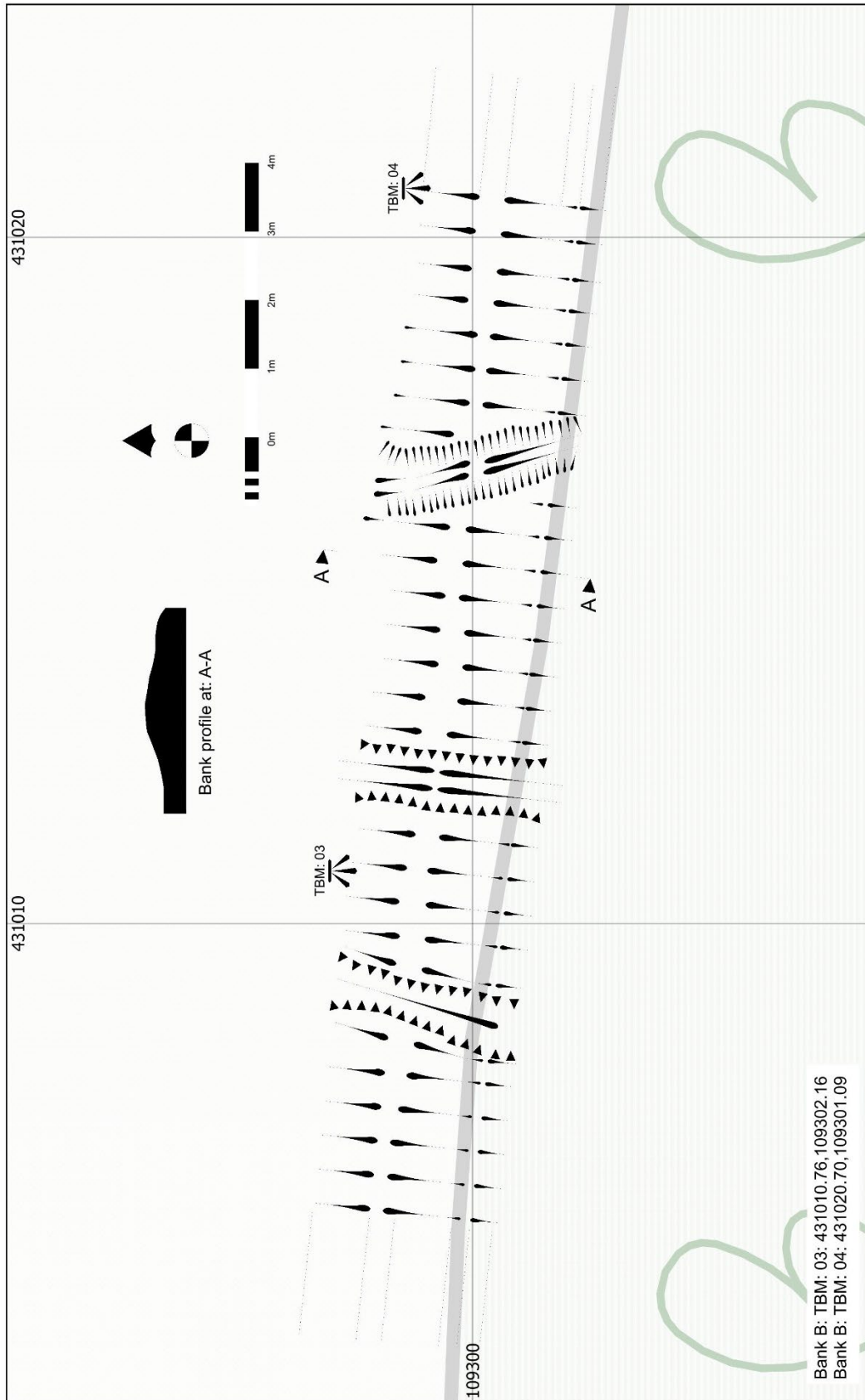

| | | |
|--|------------------|-----------------------|
| Map: 5 | Date: 24/06/2025 | Dunces Arch Inclosure |
| | Drawn by: GDO | |
| Plan and profile of bank Section B. | | |

© Crown copyright and database rights 2025.
Ordnance Survey AC000049959
You are not permitted to copy, sub-license, distribute or sell any of this data to third parties in any form.
© Copyright New Forest National Park Authority 2025.

Figure 5: Survey drawing of bank segment B, over base mapping.

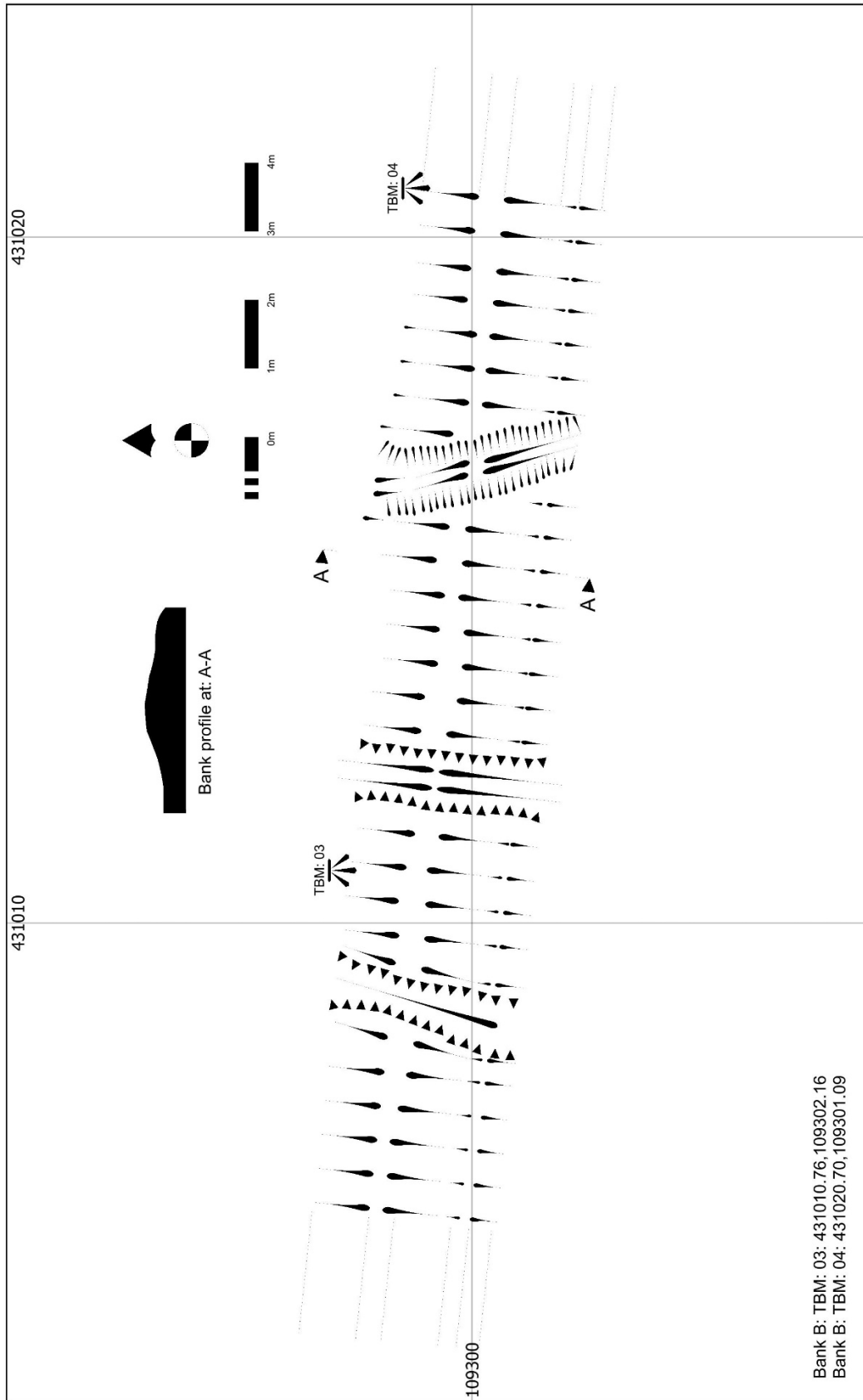

| | | |
|--|-----------------------|--|
| Map: 5i | Date: 24/06/2025 | © Crown copyright and database rights 2025. Ordnance Survey AC0000849659 You are not permitted to copy, sub-license, distribute or sell any of this data to third parties in any form. © Copyright New Forest National Park Authority 2025. |
| | Drawn by: GDO | |
| Plan and profile of bank Section B. | Dunces Arch Inclosure | |

Figure 6: Survey plan and sections of bank segment B.

8. PLATES



Photo 1: Barrow, prior to groundworks. Looking east.



Photo 2: Barrow, post groundworks. Looking east.



Photo 3: Working photograph of barrow area. Looking east.



Photo 4: Bank segment A. Looking south.



Photo 5: Bank segment B. Looking south.

New Forest National Park Authority
Lymington Town Hall
Avenue Road
Lymington
SO41 9ZG

Switchboard: 01590 646600
Website: www.newforestnpa.gov.uk

© 2025, New Forest National Park Authority